

# BETTLES, MILES & HOLLAND

## Estate Agents - Valuers

Registered Office: 15 SEAVIEW STREET, CLEETHORPES, NORTH EAST LINCOLNSHIRE, DN35 8EU

Telephone: (01472) 691455 / 698698

Email: [info@bmhestateagents.co.uk](mailto:info@bmhestateagents.co.uk)

To view our Properties on the Internet:

[www.bmhestateagents.com](http://www.bmhestateagents.com)

[www.rightmove.co.uk](http://www.rightmove.co.uk)

[www.onthemarket.com](http://www.onthemarket.com)

[www.zoopla.co.uk](http://www.zoopla.co.uk)

### PROPERTY FOR SALE

### 16 - 18 CAMBRIDGE STREET, CLEETHORPES



We are pleased to offer for rent a ground floor shop which has previously been used as an office but has also been used as a Jewelry Shop and Clothes Shop. It is in a great location by Seaview Street with Wardall Street car park just around the corner.

Front, 14 deep x 96 x 7 with a tiled floor, suspended ceiling and lighting , kitchen units, sink unit, separate toilet, wash hand basin and extractor.

£140 holding deposit required when applying for this property



**PURCHASE PRICE £650 PCM**

# 16 - 18 CAMBRIDGE STREET, CLEETHORPES

## GROUND FLOOR

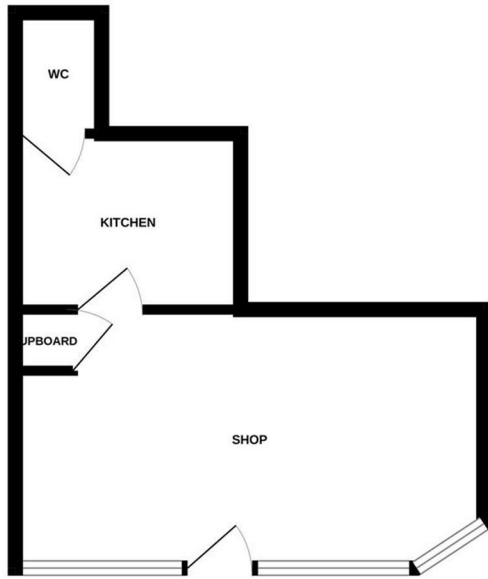

Whilst every attempt has been made to ensure the accuracy of the floorplan contained here, measurements of doors, windows, rooms and any other items are approximate and no responsibility is taken for any error, omission or mis-statement. This plan is for illustrative purposes only and should be used as such by any prospective purchaser. The services, systems and appliances shown have not been tested and no guarantee as to their capability or efficiency can be given.  
Made with Metropix ©2025

VIEWING

By appointment with this office

COUNCIL TAX BAND

TENURE

We understand the property to be , but this is to be confirmed by the solicitors

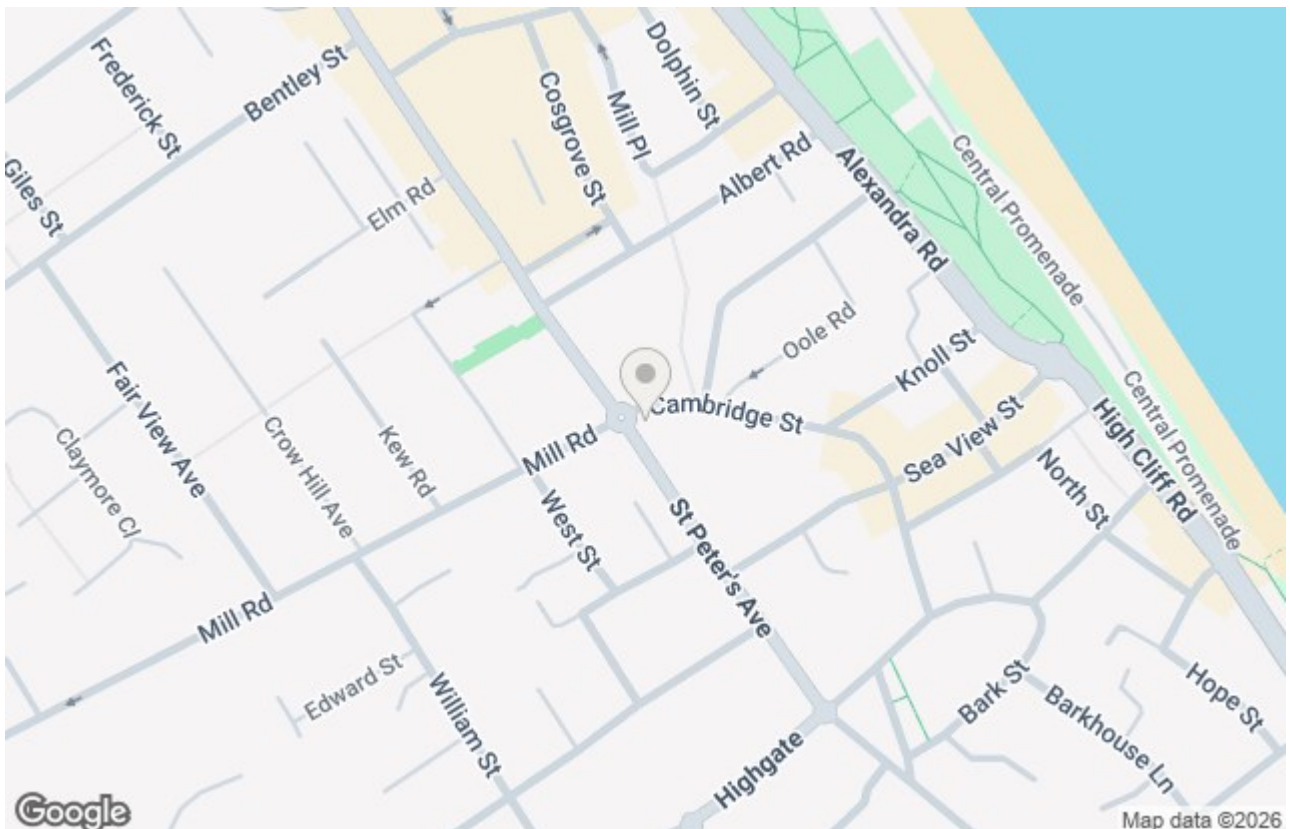
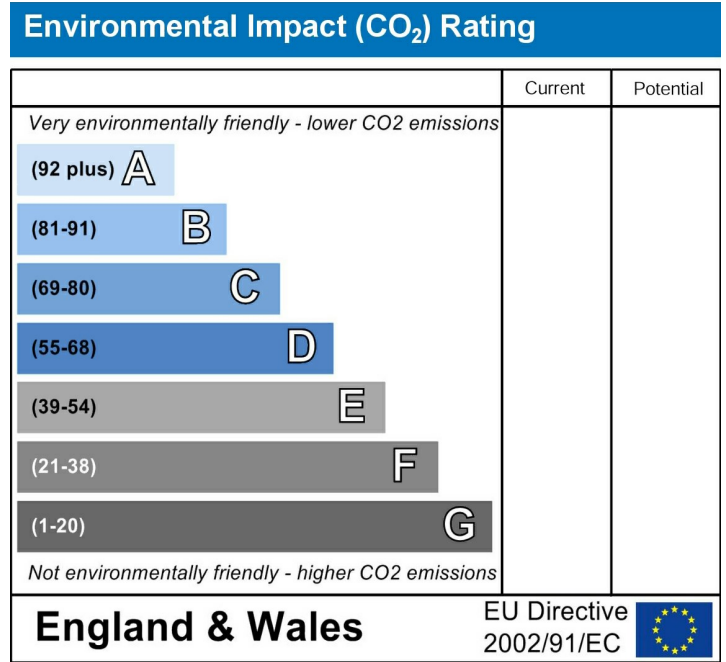
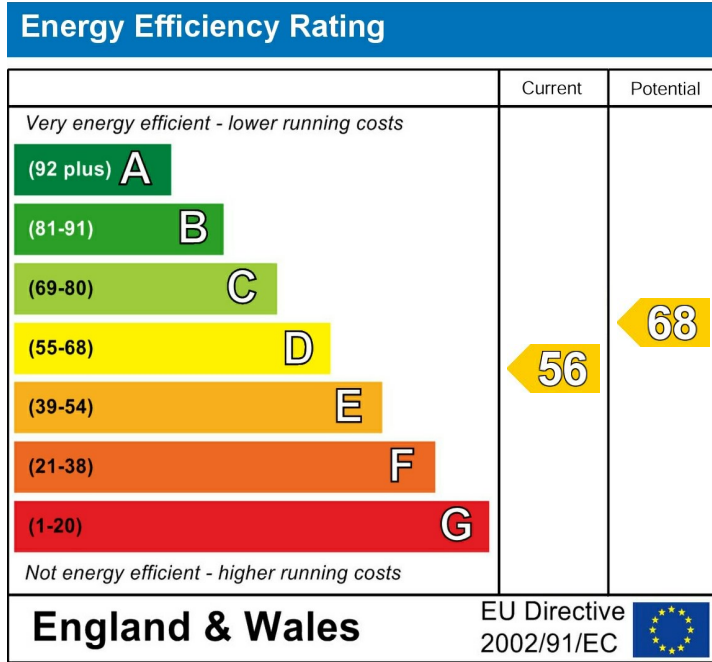

## GROUND FLOOR

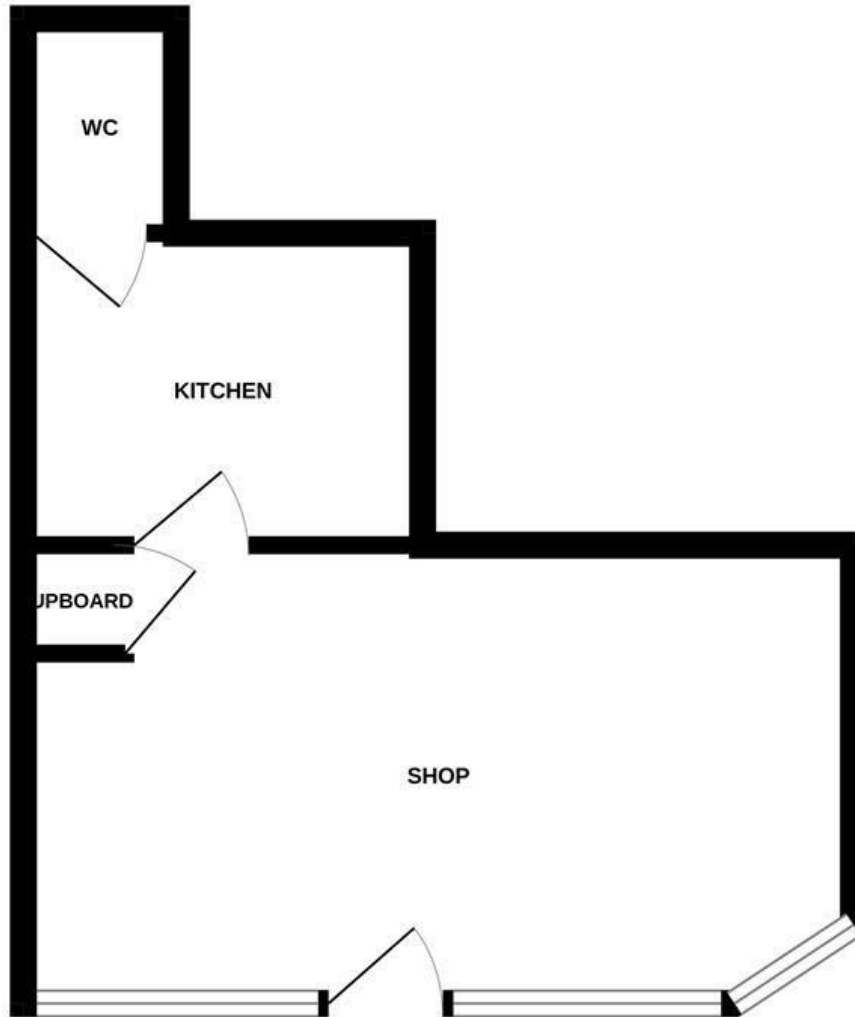

Whilst every attempt has been made to ensure the accuracy of the floorplan contained here, measurements of doors, windows, rooms and any other items are approximate and no responsibility is taken for any error, omission or mis-statement. This plan is for illustrative purposes only and should be used as such by any prospective purchaser. The services, systems and appliances shown have not been tested and no guarantee as to their operability or efficiency can be given.  
Made with Metropix ©2026

## ADDITIONAL NOTES

### **FREE VALUATIONS:**

We offer a free valuation with no obligation, just call the office on 01472 698698 and ask for your free valuation, we are flexible with our times.

### **B.M.H. PROPERTY MANAGEMENT.**

We offer a letting/management service:-

Four weekly payments / Regular inspections / credit checks / Our monthly fee is 12% **Inclusive of VAT** (i.e. 10% + V.A.T.) Call us if you are interested.

### **MORTGAGE ADVICE**

#### **WE CAN OFFER INDEPENDENT MORTGAGE ADVICE**

Our local broker Emma Hyldon can help you find the best mortgage to suit you providing personal face to face expert advice either at our office or in the comfort of your own home.

Contact our office for further details on 01472 698698 or speak to Emma Hyldon directly on 07522 622 159 or [emma@personal-touch-mortgages.co.uk](mailto:emma@personal-touch-mortgages.co.uk).

Bettles, Miles and Holland Estate Agents is an introducer to Personal Touch Mortgages (Lincs) Ltd, which is an appointed representative of PRIMIS Mortgage Network, which is authorised and regulated by the Financial Conduct Authority.

*YOUR HOME MAY BE REPOSSESSED IF YOU DO NOT KEEP UP REPAYMENTS ON YOUR MORTGAGE.*

*They normally charge a fee for mortgage advice. The amount will depend on your circumstances. A typical fee would be £99 payable upon application and further £300 payable on production of offer.*

*(BMH may recommend the services of Emma Hyldon Personal Touch Mortgages but it is entirely sellers/potential buyers own decision to use the services and they are under no obligation to do so. BMH receive a referral fee/benefits worth £75 per mortgage completion. This has NO effect on the price sellers/potential buyers pay for the Mortgage Advice. It is purely an agreement between BMH and Emma Hyldon.)*

**STATUTORY NOTICE: YOUR HOME IS AT RISK IF YOU DO NOT KEEP UP REPAYMENTS ON A MORTGAGE OR OTHER LOAN SECURED ON IT.**

**\* ALL MEASUREMENTS STATED ARE APPROXIMATE.**

Please note that none of the apparatus, equipment, whether gas or electrical have been tested and that we cannot verify that they are in full working order. We have done our utmost to provide fair, decent and honest information, we will not accept liability for any errors regarding measurements, council tax band, tenure etc, as they are for your general use only and not to be relied upon. We advise that you make your own enquiries. Should a purchaser require inspections or quotes for works on a property due to survey results, although we are only too pleased to recommend firms, we will not be held responsible for any works carried out before or after completion, or works not detected by the firms in question, they are only recommendations and have no connection with Bettles, Miles & Holland